

imageRUNNER ADVANCE DX 6800 Series

SECURE, SUSTAINABLE A3 MONO MULTIFUNCTION DEVICES WITH INTEGRATED CLOUD-BASED SOFTWARE TO EXPEDITE PRINTING AND DOCUMENT DIGITISATION

MAIN CONFIGURATION OPTIONS



Canon Europe Ltd.
EU 2022-2024 Most Reliable A3 Brand



Canon uniFLOW OnJine
Outstanding Cloud Output Management Solution



Canon Europe Ltd.
EU 2022-24 Line of the Year

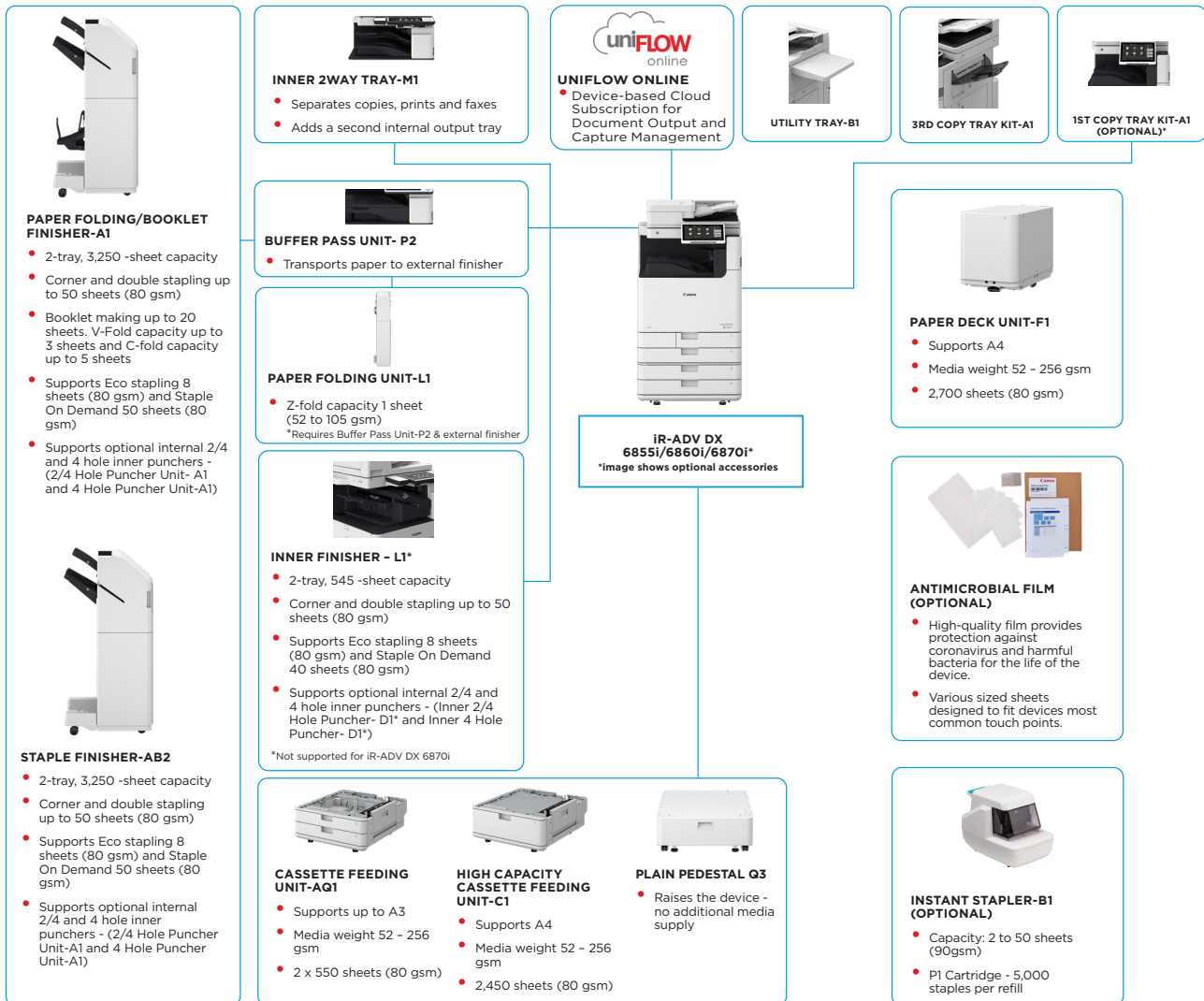

This flat configuration is for illustration purpose only. For a complete list of options and the exact compatibility relationships, please refer to the online [product configurator](#).

The Unified Firmware Platform (UFP) ensures that the latest feature upgrades and protection are available, for an enhanced user experience across the entire iR ADVANCE DX portfolio.

*To support sustainability and save on raw materials required for plastics, 1st Copy Tray Kit-A1 is optional.



TECHNICAL SPECIFICATIONS

imageRUNNER ADVANCE DX 6800 Series

MAIN UNIT		Fonts	PS fonts: 136 Roman PCL fonts: 93 Roman, 10 Bitmap fonts, 2 OCR fonts, Andale Mono WT J/k/S/T ¹ (Japanese, Korean, Simplified and Traditional Chinese), Barcode fonts ² ¹ Optional PCL International Font Set-A1 is required. ² Optional Barcode Printing Kit-D1 is required.
Machine type	A3 Monochrome Laser Multifunctional	Print Features	Secured Print, Secure Watermark, Header/Footer, Page Layout, Two-sided Printing, Mixed Paper Sizes/Orientations, Front/Back Covers, Toner Reduction, Poster Printing, Forced Hold printing, Print Date, Scheduled Printing, Printing Using a Virtual Printer
Core functions	Print, Copy, Scan, Send, Store and Optional Fax	Operating System	UFR II: Windows® 8.1/10/11/Server2012/Server2012 R2/Server2016/Server2019/Server2022, Mac OS X (10.11 or later) PCL: Windows® 8.1/10/11/Server2012/Server2012 R2/Server2016/Server2019/Server2022 PS: Windows® 8.1/10/11/Server2012/Server2012 R2/Server2016/Server2019/Server2022, Mac OS X (10.11 or later) PPD: Windows® 8.1/10/11, Mac OS X(10.11 or later) As of Jan. 2022
Processor	1.8GHz Dual Core Processor	COPY SPECIFICATIONS	
Control Panel	10.1" TFT LCD WSVGA Color Touch panel	Copy Speed (BW)	iR-ADV DX 6870i up to 70 ppm (A4, A5*, A5R, A6R*), up to 36 ppm (A3), up to 42 ppm (A4R) iR-ADV DX 6860i up to 60 ppm (A4, A5*, A5R, A6R*), up to 32 ppm (A3), up to 36 ppm (A4R) iR-ADV DX 6855i up to 55 ppm (A4, A5*, A5R, A6R*), up to 29 ppm (A3), up to 36 ppm (A4R) * 1-sided only
Memory	Standard: RAM 5GB Main CPU: 2GB Image Processing CPU: 2GB + 1GB (reserved for image processing)	First-Copy-Out Time (A4, BW)	iR-ADV DX 6870i: Approx. 2.7 seconds or less iR-ADV DX 6860i: Approx. 2.9 seconds or less iR-ADV DX 6855i: Approx. 2.9 seconds or less
Storage	Standard: (SSD) 256GB, Optional: (SSD) 1TB	Copy resolution (dpi)	600 x 600
Interface Connection	NETWORK Standard: 1000Base-T/100Base-TX/10Base-T, Wireless LAN (IEEE 802.11 b/g/n); Optional: Bluetooth Low Energy OTHERS Standard: USB 2.0 (Host) x1, USB 3.0 (Host) x1, USB 2.0 (Device) x1; Optional: Serial Interface, Copy Control Interface	Multiple Copies	Up to 9,999 copies
Paper Supply Capacity (A4, 80gsm)	Standard: 1,200 sheets 100-sheet Multi-purpose tray x 1 550-sheet Paper cassettes x 2 Maximum: 6,350 sheets (with High Capacity Cassette Feeding Unit-C1 + Paper Deck Unit-F1)	Copy Density	Automatic or Manual (9 Levels)
Paper output capacity (A4, 80gsm)	Maximum: 3,450 Sheets (with Staple Finisher-AB2 or Paper Folding/Booklet Finisher- A1 and 3rd Copy Tray Kit-A1)	Magnification	Variable zoom: 25% to 400% (1% Increments) Preset reduction/enlargement: 25%, 50%, 70%, 100%(1:1), 141%, 200%, 400%
Finishing capabilities	Collate, Group, Offset, Staple, Saddle Stitch, Hole Punch, Eco Staple, Staple On Demand, V-fold, C-fold, Z-fold * Finishing capabilities vary depending on the options connected.	Copy Features	Preset R/E Ratios by Area, Two-Sided, Density Adjustment, Original Type Selection, Interrupt Mode, Book to Two Pages, Two-sided Original, Job Build, N on 1, Add Cover, Insert Sheets, Different Size Originals, Page Numbering, Copy Set Numbering, Sharpness, Erase Frame, Secure Watermark, Print Date, Gutter, Print & Check, Negative/Positive, Repeat Images, Merge Job Blocks, Mirror Image, Store in Mail Box, Superimpose Image, Copy ID Card, Skip Blank Pages, Free Size Original, Reserved copy, Copy Sample
Supported Media Types	Multi-purpose tray: Thin, Plain, Recycled, Color, Heavy, Coated, Tracing, Bond, Transparency, Label, Pre-punched, Letterhead, Tab, Envelope Paper Cassette (Upper/Lower): Thin, Plain, Recycled, Color, Heavy, Bond, Transparency, Pre-punched, Letterhead, Envelope* * Envelope Feeder Attachment (standard) is required.	Copy resolution (dpi)	600 x 600
Supported Media Sizes	Multi-purpose tray: Standard size: SRA3, A3, A4, A4R, A5, A5R, A6R, B4, B5, B5R Custom size: 98.0 x 139.7 mm to 320.0 x 457.2 mm Free Size: 98.0 x 139.7 mm to 320.0 x 457.2 mm Envelopes: COM 10 No.10, Monarch, DL, ISO-C5 Envelope custom size: 98.0 x 90.0 mm to 320.0 x 457.2 mm Upper Cassette: Standard size: A4, A5, A5R, A6R, B5 Custom Size: 98.0 x 148.0 mm to 297.0 x 215.9 mm Envelopes: COM10 No.10, Monarch, DL, ISO-C5 Lower Cassette: Standard size: A3, A4, A4R, A5, A5R, A6R, B4, B5, B5R Custom size: 98.0 x 148.0 mm to 304.8 x 457.2 mm Envelopes: COM10 No.10, Monarch, DL, ISO-C5	Copy Density	Automatic or Manual (9 Levels)
Supported media weights	Multi-purpose tray: 52 to 300 gsm Paper Cassettes (Upper/Lower): 52 to 256 gsm Duplex: 52 to 256 gsm	Magnification	Variable zoom: 25% to 400% (1% Increments) Preset reduction/enlargement: 25%, 50%, 70%, 100%(1:1), 141%, 200%, 400%
Warm-up Time	Quick Startup Mode: 4 Seconds or less * * Time from device power-on to when the copy icon appears and is enabled to operate on the touch panel display. From Sleep Mode: 7 seconds or less (iR-ADV DX 6870i) 6 seconds or less (iR-ADV DX 6860i/iR-ADV DX 6855i) From Power On: 6 Seconds or less* * Time from device power-on, until copy ready (not print reservation).	Copy Features	Preset R/E Ratios by Area, Two-Sided, Density Adjustment, Original Type Selection, Interrupt Mode, Book to Two Pages, Two-sided Original, Job Build, N on 1, Add Cover, Insert Sheets, Different Size Originals, Page Numbering, Copy Set Numbering, Sharpness, Erase Frame, Secure Watermark, Print Date, Gutter, Print & Check, Negative/Positive, Repeat Images, Merge Job Blocks, Mirror Image, Store in Mail Box, Superimpose Image, Copy ID Card, Skip Blank Pages, Free Size Original, Reserved copy, Copy Sample
Dimensions (W x D x H)	620 x 722 x 937 mm	SCAN SPECIFICATION	
Installation Space (W x D)	Basic: 1,138 x 1,162 mm (Right Cover Open with Multi-purpose tray extended + Cassette Drawers Open) Fully Configured: 1,866 x 1,162 mm (Staple Finisher-AB2/ Paper Folding/Booklet Finisher-A1 with the extension tray extended + Paper Deck Unit-F1 + Cassette Drawers open)	Type	Single-pass Duplexing Automatic Document Feeder* [2-sided to 2-sided (Automatic)] * Detect Feeder Multi Sheet Feed is supported. up to 200 Sheets
Weight*	iR-ADV DX 6870i: Approx. 93 kg iR-ADV DX 6860i: Approx. 91 kg iR-ADV DX 6855i: Approx. 91 kg	Document Feeder Paper Capacity (80 gsm)	up to 200 Sheets
PRINT SPECIFICATIONS		Acceptable Originals and weights	Platen: Sheet, Book, and 3-Dimensional Objects Document Feeder media weight: 1-sided scanning: 38 to 220 gsm 2-sided scanning: 38 to 220 gsm * An acceptable weights of A6R or smaller is 50 to 220gsm.
Print Speed (BW)	iR-ADV DX 6870i up to 70 ppm (A4, A5*, A5R, A6R*), up to 36 ppm (A3), up to 42 ppm (A4R) iR-ADV DX 6860i up to 60 ppm (A4, A5*, A5R, A6R*), up to 32 ppm (A3), up to 36 ppm (A4R) iR-ADV DX 6855i up to 55 ppm (A4, A5*, A5R, A6R*), up to 29 ppm (A3), up to 36 ppm (A4R) * 1-sided only	Supported media sizes	Platen scanning size: up to 297.0 x 431.8 mm Document Feeder media size: A3, A4, A4R, A5, A5R, A6R, B4, B5, B5R, B6R Custom size: 70.0 x 139.7 mm to 304.8 x 431.8 mm
Print Resolution (dpi)	1,200 x 1,200	Scan Speed (ipm: BW/CL; A4)	1-sided Scanning: 135/135 (300 x 300 dpi, send), 80/80 (600 x 600 dpi, copy) 2-sided Scanning: 270/270 (300 x 300 dpi, send), 160/90 (600 x 600 dpi, copy)
Page description languages	Standard: UFR II, PCL6 Optional: Adobe® PostScript®3™	Scan Resolution (dpi)	Scan for Copy: 600 x 600 Scan for Send: (Push) 600 x 600 (SMB/FTP/WebDAV/IFAX), (Pull) 600 x 600 Scan for Fax: 600 x 600
Direct Print	Supported file types: PDF, EPS, TIFF/JPEG, and XPS	Pull Scan Specifications	Color Network ScanGear2. For both TWAIN and WIA Supported OS: Windows® 8.1/10/11/Server2012/Server2012 R2/Server 2016/Server 2019/Server 2022 As of Nov. 2021
Printing from mobile and cloud	AirPrint, Mopria, Universal Print by Microsoft, Canon PRINT Business App, and uniFLOW Online (optional) A range of software and MEAP-based solutions are available to provide printing from mobile devices or internet-connected devices and cloud-based services depending on your requirements. Please contact your sales representative for further information.	Scan Method	Push Scan, Pull Scan, Scan to Box, Scan to Advanced Space, Scan to Network, Scan to USB Memory Key, Scan to Mobile devices, Scan to cloud (uniFLOW Online - Optional)
OS Standard Printing	Android/Windows® 10/Windows® 11/Chrome OS/macOS (11.2.2 or later)/iOS (15.2 or later)/iPadOS	SEND SPECIFICATIONS	
		Destination	Standard: E-mail/Internet FAX (SMTP), SMB3.0, FTP, FTPS WebDAV, Mail Box Optional: Super G3 FAX, IP Fax
		Address Book	LDAP (2,000)/Local (1,600)/Speed dial (200)
		Send resolution (dpi)	Push: up to 600 x 600 Pull: up to 600 x 600
		Communication protocol	File: FTP(TCP/IP), SMB3.0 (TCP/IP), WebDAV E-mail/I-Fax: SMTP, POP3
		File Format	TIFF, JPEG, PDF(Compact, Searchable, Apply policy, Optimize for Web, PDF/A-1b, Trace & Smooth, Encrypted, Device Signature, User Signature), XPS(Compact, Searchable, Device Signature, User Signature), Office Open XML (PowerPoint, Word)

TECHNICAL SPECIFICATIONS

imageRUNNER ADVANCE DX 6800 Series

Universal Send Features	Original Type Selection, Two-sided Original, Book to Two Pages, Different-size Originals, Density Adjustment, Sharpness, Copy Ratio, Erase Frame, Job Build, Delayed Send, Preview, Job Done Notice, File Name, Subject/Message, Reply-to, E-mail Priority, TX Report, Original Content Orientation, Skip Blank Pages	ENVIRONMENTAL SPECIFICATIONS	
FAX SPECIFICATIONS		Operating Environment	Temperature: 10 to 30 °C Humidity: 20 to 80 % RH (Relative Humidity) 220-240 V, 50/60 Hz, 6 A
Maximum Number of Connection Lines	1	Power source	Maximum: iR-ADV DX 6870i: Approx. 2,000 W iR-ADV DX 6860i: Approx. 1,800 W iR-ADV DX 6855i: Approx. 1,800 W Copying (with DADF continuous scan): Approx. 858 W ¹ Standby: Approx. 50.7 W ² Sleep mode: Approx. 0.8 W ²
Modem Speed	Super G3: 33.6 kbps G3: 14.4 kbps	Power consumption	¹ Reference value: measured one unit ² 0.8 W is not available in all circumstances due to certain settings.
Compression Method	MH, MR, MMR, JBIG	Noise levels (BW)	Typical Electricity Consumption (TEC): iR-ADV DX 6870i: 0.85 kWh iR-ADV DX 6860i: 0.71 kWh iR-ADV DX 6855i: 0.67 kWh * As per USA Energy Star 3.0
Resolution (dpi)	400 x 400 (Ultra Fine), 200 x 400 (Super Fine), 200 x 200 (Fine), 200 x 100 (Normal)		Sound Power Level (LWA,m) Active (1-sided) iR-ADV DX 6870i: 6.6 B*, Kv 0.3 B* iR-ADV DX 6860i: 6.4 B*, Kv 0.3 B* iR-ADV DX 6855i: 6.4 B*, Kv 0.3 B* * Reference value: measured only one unit with ISO7779, described with ISO9296 (2017)
Sending/Receiving Size	Sending: A3, A4, A4R, A5 ¹ , A5R ¹ , B4, B5 ² , B5R ⁴ Receiving: A3, B4, A4, A4R, A5R, B5, B5R ¹ Sent as A4 ² Sent as B4 short	Standards	Sound Pressure (LpA,m) Bystander's position: Active (1-sided): 52 dB* (iR-ADV DX 6870i), 51 dB* (iR-ADV DX 6860i) 50 dB* (iR-ADV DX 6855i) Stand-by: 25 dB* * Reference value: measured only one unit with ISO7779, described with ISO9296 (2017)
FAX memory	Up to 30,000 pages (2,000 jobs)		Blue Angel
Speed dials	Max. 200	CONSUMABLES	
Group dials/destinations	Max. 199 dials	Toner Cartridges	C-EXV 61 Toner BK
Sequential broadcast	Max. 256 addresses	Toner Yield (Estimated Yield @6% coverage)	C-EXV 61 Toner BK: 71,500 pages
Memory backup	Yes	SOFTWARE AND PRINTER MANAGEMENT	
Fax Features	Sender's Name (TTI), Selecting the Telephone Line (when sending fax), Direct Send, Delayed Send, Preview, Job Done Notice, TX Report, Interrupt Transmission, Sequential Broadcasting, Password/Subaddress Sending, Confidential Mailbox, 2 on 1 Log	Tracking and reporting	Universal Login Manager (ULM) uniFLOW Online Express * For more information, please refer to uniFLOW Online Express uniFLOW Online
STORE SPECIFICATIONS		Remote management tools	iWEMC eMaintenance Content Delivery System
Mail Box (Number supported)	100 User Inboxes, 1 Memory RX Inbox, 50 Confidential Fax Inboxes Maximum 30,000 Pages (2,000 jobs) Stored	Scanning software	Network ScanGear
Advanced Space	Communication Protocol: SMB or WebDAV Supported Client PC: Windows® 8.1/10 Concurrent Connections (Max.): SMB:64, WebDAV:3	Optimisation tools	Canon Driver Configuration Tool
Advanced Space available disc space	Standard:16 GB (With option: max. 480GB)	Platform	MEAP (Multifunctional Embedded Application Platform)
Advanced Space Features	Authentication for Advanced Space Log-in, Sort Function, Printing a PDF File with a Password, imageWARE Secure Audit Manager Support, Search, File Preview, Authentication Management, Open to public, URI TX, Backup/Restore	Document Publishing	Kofax PowerPDF Advanced (Optional)
SECURITY SPECIFICATIONS		PAPER SUPPLY OPTIONS	
Authentication and Access Control	User Authentication (Picture Login, Picture and PIN Login, Card Login*, Username and Password Login, Function Level Login, Mobile Login), Department ID Authentication (Department ID and PIN Login, Function Level Login), uniFLOW Online Express (PIN Login, Picture Login, Picture and PIN Login, Card Login, Card and PIN Login, Username and Password Login, Department ID and PIN Login, Function Level Login), Access Management System (Access Control) * Card readers are optional, please refer to Hardware Accessories Activation is required	Cassette Feeding Unit-AQ1	Paper Capacity: 2 x 550 sheets (80 gsm) Paper Type: Thin, Plain, Recycled, Color, Heavy, Bond, Transparency, Pre-punched, Letterhead Paper Size: A3, A4, A4R, A5, A5R, A6R, B4, B5, B5R Custom size: 98.0 x 148.0 mm to 304.8 x 457.2 mm Paper Weight: 52 to 256 gsm Dimensions (W x D x H): 620 x 660 x 251 mm (attached to the main unit) Weight: Approx. 22 kg
Document Security	Print Security (Secure Print, Encrypted Secure Print, Forced Hold Printing, uniFLOW Secure Print*), Receive Data Security (Confidential Fax Inbox Forwarding Received Documents Automatically), Scan Security (Encrypted PDF, Device Signature PDF/XPS, User Signature PDF/XPS, Adobe LiveCycle® Rights Management ES2.5 Integration), BOX Security (Mail Box Password Protected, Advanced Space Access Control), Send Data Security (Setting for requesting password input per transmission, Restricted E-mail/File send functions, Confirming FAX number, Allow/Restrict Fax Driver Transmissions, Allow/Restrict Sending from History, S/MIME Support), Document Tracking (Secure Watermark) ¹ Requires uniFLOW Online / uniFLOW	High Capacity Cassette Feeding Unit-C1	Paper Capacity: 2,450 sheets (80 gsm) Paper Type: Thin, Plain, Recycled, Color, Heavy, Bond, Pre-punched, Letterhead Paper Size: A4 Paper Weight: 52 to 256 gsm Dimensions (W x D x H): 620 x 660 x 251 mm (attached to the main unit) Weight: Approx. 29 kg
Network Security	TLS 1.3, IPSec, IEEE802.1X authentication, SNMP V3.0, Firewall Functionality (IP/MAC Address Filtering), WPA3 support (Wi-Fi), Dual Network Support (Wired LAN/Wireless LAN, Wired LAN/Wired LAN), Disabling Unused Functions (Enabling/Disabling Protocols/Applications, Enabling/Disabling Remote UI, Enabling/Disabling USB Interface), G3 FAX separation from LAN, USB Port separation from LAN, Prohibit the execution of files stored in Advanced Box in the MFP, Scan and Send -Virus Concerns for E-mail Reception	Paper Deck Unit-F1	Paper Capacity: 2,700 sheets (80 gsm) Paper Type: Thin, Plain, Color, Recycled, Heavy, Pre-punched Paper Size: A4, B5 Paper Weight: 52 to 256 gsm Dimensions (W x D x H): 344 x 630 x 440 mm (attached to the main unit) Weight: Approx. 31 kg
Device Security	Protecting SSD Data [SSD Data Encryption (FIPS140-2 Validated), SSD Lock], Standard SSD Initialize, Trusted Platform Module (TPM 2.0), Job Log Conceal Function, Protecting MFD Software Integrity, Checking MFD Software Integrity (Verify System at Startup, Runtime Intrusion Detection enabled with McAfee Embedded Control), HCD-PP Common Criteria Certification (pending confirmation)	OUTPUT OPTIONS*	* Paper capacity may vary with different paper type/size.
Device Management and Auditing	Administrator Password, Digital Certificate And Key Management, Audit Log, Cooperating with External Security Audit System (Security Information and Event Management), Image Data Logging, Security Policy Setting	1st Copy Tray Kit-A1	Capacity (with 80gsm paper): A4, A5, A5R, A6R, B5: 250 sheets SRA3, A3, A4R, B4, B5R: 100 sheets Paper Weight: 52 to 300 gsm Dimensions (W x D x H): 454 x 493 x 114 mm Weight: 1.2 kg
		Inner 2way Tray-M1	Tray Capacity (with 80 gsm paper) Upper tray: A4, A5, A5R, A6R, B5: 100 sheets SRA3, A3, A4R, B4, B5R: 50 sheets Lower tray (1st Copy Tray Kit-A1): A4, A5, A5R, A6R, B5: 250 sheets SRA3, A3, A4R, B4, B5R: 100 sheets Paper Weight: 52 to 300 gsm Dimensions (W x D x H): 428 x 405 x 88 mm Weight: Approx. 0.7 kg

TECHNICAL SPECIFICATIONS

imageRUNNER ADVANCE DX 6800 Series

3rd Copy Tray Kit-A1	<p>Capacity (with 80gsm paper): A4, A5R, B5: 100 sheets A3, A4R, B4, B5R: 75 sheets Dimensions (W x D x H): 442 x 373 x 176 mm (attached to the main unit, when the extension tray is extended) Weight: 0.5 kg</p>	2/4 Hole Puncher Unit-A1	<p>(Requires either the Staple Finisher-AB2 or Paper Folding/Booklet Finisher-A1) Two or Four Holes Acceptable Punch Paper Weight: 52 to 300 gsm Acceptable Punch Paper Size: Two holes: A3, A4, A4R, A5, B4, B5, B5R Four holes: A3, A4</p>
Inner Finisher-L1 (Not supported for IR-ADV DX 6870i)	<p>Tray Capacity (with 80gsm paper): Upper Tray: SRA3, A3, A4, A4R, A5, A5R, A6R, B4, B5, B5R: approx. 45 sheets Lower Tray: A4, A5, A5R, B5: approx. 500 sheets, SRA3, A3, A4R, B4, B5R: 250 sheets, A6R: 30 sheets Envelope: 10 sheets Paper Weight: 52 to 300 gsm Staple Position: Corner, Double Staple Capacity: (52 to 90 gsm paper) A4, B5: 50 sheets A4R: 40 sheets A3, B4: 30 sheets Eco Staple: A3, A4, B4, B5: 10 sheets (52 to 64 gsm) 8 sheets (65 to 81.4 gsm) 6 sheets (82 to 105 gsm) Staple On Demand: 40 sheets (80 gsm) Dimensions (W x D x H): 743 x 525 x 225 mm (attached to the main unit, when the extension tray is extended) Weight: Approx. 9.1 kg</p>	4 Hole Puncher Unit-A1	<p>(Requires either the Staple Finisher-AB2 or Paper Folding/Booklet Finisher-A1) Four Holes Acceptable Punch Paper Weight: 52 to 300 gsm Acceptable Punch Paper Size: Four holes A3, A4, A4R, A5, B4, B5, B5R</p>
Staple Finisher-AB2	<p>(Requires Buffer Pass Unit-P2) Tray Capacity (with 80gsm paper): Upper Tray: A4, A5, A5R, A6R, B5: approx. 250 sheets, SRA3, A3, A4R, B4, B5R: approx. 125 sheets Lower Tray: A4, A5, A5R, B5: 3,000 sheets, SRA3, A3, A4R, B4, B5R: 1,500 sheets, A6R: 250 sheets Envelopes: Monarch: 30 sheets, COM10 No.10, DL, ISO-C5: 100 sheets Paper Weight: Upper Tray 52 to 256 gsm, Lower Tray 52 to 300 gsm Staple Position: Corner, Double Staple Capacity: (52 to 90 gsm) A4, B5: 50 sheets A4R: 40 sheets A3, B4: 30 sheets Eco Staple: A3, A4: 10 sheets (52 to 64 gsm) 8 sheets (65 to 81.4 gsm) 6 sheets (82 to 105 gsm) Staple On Demand: 50 sheets (52 to 90 gsm) Dimensions (W x D x H): 637 x 623 x 1,142 mm (when the extension tray is extended) Weight: Approx. 31 kg</p>	HARDWARE ACCESSORIES Card Readers Others SECURITY OPTIONS Data Security SYSTEM AND CONTROLLER OPTIONS Print Accessories Barcode Printing System Accessories Fax Accessories OTHER OPTIONS Accessibility Accessories	<p>Various card readers available e.g. MiCard Plus. Please contact local Canon Office for more details Copy Card Reader-F1 IC Card Reader Box for Numeric Keypad-A1 Printer Cover-M2 Tab Feeding Attachment-F1 Buffer Pass Unit-P2 Utility Tray-B1 Numeric Keypad-A2 Instant Stapler-B1 (optional) 250GB SSD-A1 (usage with Memory Mirroring Kit-A1) 1TB SSD-A1 Memory Mirroring Kit-A1 PCL International Font Set-A1 PS Printer Kit-BC1 Barcode Printing Kit-D1 Copy Control Interface Kit-A1 Serial Interface Kit-K3 Connection Kit-A3 for Bluetooth LE Super G3 FAX Board-AX1 Remote Fax Kit-A1 IP FAX Expansion Kit-B1 ADF Access Handle-A1 Voice Guidance Kit-G1 Voice Operation Kit-D1</p>
Paper Folding/Booklet Finisher-A1	<p>(Requires Buffer Pass Unit-P2) (Includes the above Staple Finisher-AB2 basic staple specifications.) Saddle Stitch paper size: A3, A4R, B4 Saddle Stitch Staple Capacity: 20 sheets x 10 sets (52 to 81.4 gsm) (including 1 cover sheet 52 to 256 gsm) V-fold Capacity: up to 3 sheets (52 to 105 gsm) C-fold Capacity: up to 5 sheets (52 to 128 gsm) Dimensions (W x D x H): 637 x 623 x 1,142 mm (when the extension tray is extended) Weight: Approx. 57 kg</p>	Consumables Device Protection	<p>Staple-P1 (2 x 5,000pcs) Staple Cartridge-Y1 (2 x 2,000pcs)* * For Booklet Finisher only Antimicrobial Film* - Various Sheets designed to fit the devices most common touch points. *Application by a Service engineer is recommended</p>
Paper Folding Unit-L1	<p>(Requires Buffer Pass Unit-P2 & external finisher) Paper size: A3, A4, B4 Z-fold Capacity: 1 sheet (52 to 105 gsm) Dimensions (W x D x H): 201 x 579 x 896 mm Weight: Approx. 12 kg</p>		
Inner 2/4 Hole Puncher-D1 (Not supported for IR-ADV DX 6870i)	<p>(Requires the Inner Finisher-L1) Two or Four Holes Acceptable Punch Paper Weight: 52 to 300 gsm Acceptable Punch Paper Size: Two holes: A3, A4, A4R, A5, B4, B5, B5R Four holes: A3, A4</p>		
Inner 4 Hole Puncher-D1 (Not supported for IR-ADV DX 6870i)	<p>(Requires the Inner Finisher-L1) Four Holes Acceptable Punch Paper Weight: 52 to 300 gsm Acceptable Punch Paper Size: Four holes: A3, A4, A4R, A5, B4, B5, B5R</p>		

Software & Solutions



Certifications and compatibility



Canon Ireland
3006 Lake Drive
Citywest, Saggart
Co. Dublin, Ireland
Telephone No: 01 2052400
Facsimile No: 01 2052525
canon.ie

Canon (UK) Ltd
The Bower
4 Roundwood Avenue
Stockley Park
Uxbridge
Middlesex
UB11 1AF

Canon Inc.
canon.com
Canon Europe
canon-europe.com
English edition
© Canon Europa N.V., 2022

